

Pneumatically Actuated 3-Piece Stainless Ball Valves

Features and Benefits:

- compact design for areas with tight space restrictions
- full port design offers lower pressure drop and a less turbulent flow
- balanced encapsulated construction minimizes cold-flow of seats
- precision stainless steel balls reduce torque and friction losses while extending seat life
- blow-out proof stem
- live-loaded stem packing
- ID polish is R_a 32 minimum
- pressure rating: 1/2" - 2" **1000 PSI WOG**, 2 1/2" - 4" **800 PSI WOG**
- Virgin PTFE seats

Rack and Pinion Actuator:

- hard anodized aluminum body
- nickel plated anti-blowout pinion
- Buna-N O-rings
- NAMUR mounting
- bi-directional stops for $\pm 5^\circ$ travel adjustment
- **80 PSI** plant air required
- visual position indication
- maximum operating pressure: **120 PSI**
- operating temperature range: **-40°F to 200°F**
- tested to one million cycles



Spring Return

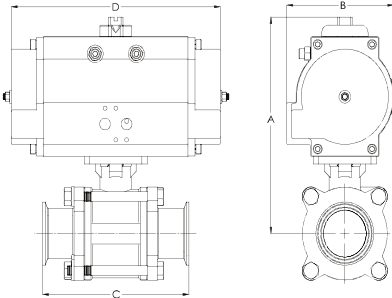

Size	A	B	C	D	316 Stainless Steel Part #
1/2"	5.26	3.21	4.33	6.84	BV2CV-050CC-BBC
3/4"	5.68	3.21	4.69	6.84	BV2CV-075CC-BBC
1"	6.00	3.21	4.89	6.84	BV2CV-100CC-BBC
1 1/2"	7.37	3.74	5.64	7.44	BV2CV-150CC-BBC
2"	8.64	4.66	6.38	9.28	BV2CV-200CC-BBC
2 1/2"	10.21	5.48	7.76	13.25	BV2CV-250CC-BBC
3"	10.54	5.48	9.13	13.25	BV2CV-300CC-BBC
4"	13.83	8.00	9.56	18.00	BV2CV-400CC-BBC

Double Acting

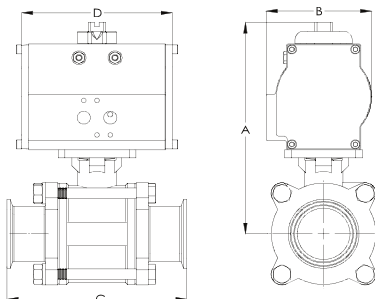

Size	A	B	C	D	316 Stainless Steel Part #
1/2"	4.93	2.90	4.33	4.73	BV2CV-050CC-BCC
3/4"	5.23	2.90	4.69	4.73	BV2CV-075CC-BCC
1"	5.98	3.23	4.89	5.58	BV2CV-100CC-BCC
1 1/2"	7.36	3.74	5.64	5.78	BV2CV-150CC-BCC
2"	7.72	3.74	6.38	5.78	BV2CV-200CC-BCC
2 1/2"	9.41	4.66	7.76	7.25	BV2CV-250CC-BCC
3"	10.54	5.48	9.13	10.63	BV2CV-300CC-BCC
4"	10.54	5.48	9.56	10.63	BV2CV-400CC-BCC

- A wide variety of seat options, switches, solenoids, positioners, etc. are available. Contact Dixon Sanitary Engineering for further assistance.